

PRESRV™

REFRIGERATOR
DRAWERS

DUAL ZONE



From snacks for the kids to the freshest produce to party-ready food and drinks, these stylish under-counter Dual Zone Refrigerator Drawers give you additional cold storage right where you need it. This large capacity refrigerator maintains two distinct temperature zones with PreciseTemp™

temperature control for maintaining accurate temperatures. Loaded with features like Quick Chill to instantly lower overall refrigerator temperature; handy temperature presets; full-extension, soft-close drawers and a sleek stainless steel exterior.

ZEPHYR
ZEPHYRONLINE.COM

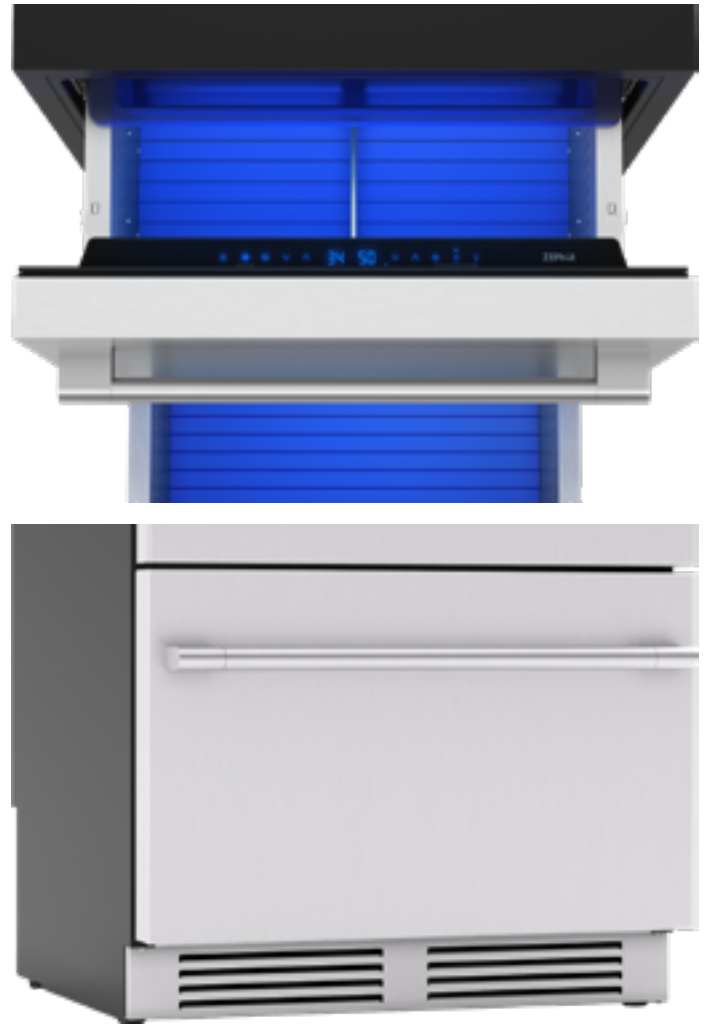

How Presrv™ Stands Out:



PreciseTemp™
Multiple internal sensors help maintain accurate temperatures



Drawer Organizers
Customizable drawer organizers help keep everything in its place



Active Cooling Technology
An on-board computer controls active cooling fans to provide temperature stability and even cooling



Soft-Close Drawers
Close more smoothly and quietly to prevent shifting of drawer contents

MODEL

Dual Zone Refrigerator Drawer	PRRD24C2AS
Size	24"
Dimensions	23-7/8"W x 33-7/8"H x 24"D
Weight	139 lbs.
Installation Type	Compact / Built-in
Refrigerant Type	R600a

FEATURES

Volume	5.1 cu/ft
Temperature Range	33° - 65° F (each zone)
Exterior Drawer Finish	304-grade Stainless Steel with Pro Handle
Interior Drawer Finish	Stainless Steel
Exterior Cabinet Finish	Black
Interior Cabinet Finish	Black
Full-Extension Drawers	Yes
Soft-Close Drawers	Yes
Silicone Drawer Mat	Yes
Drawer Organization	Adjustable Bar Dividers + Transparent Insert Tray
Lighting	3-Color LED Lighting Cloud White, Deep Blue, Amber
Controls	3-Color Electronic Touch
Preset Temperature Modes	Produce, Beverage, Wine
Quick Chill	Yes, for faster cooldown
Door Open Alarm	Yes
Dual Evaporators	Yes
Sabbath Mode	Yes
ENERGY STAR® Certified	Yes
PreciseTemp™	Yes
Active Cooling Technology	Yes

AC POWER	115V, 60Hz at Max. 1.5A
----------	-------------------------

WARRANTY	2 years parts, 2 years labor 5 years compressor
----------	--

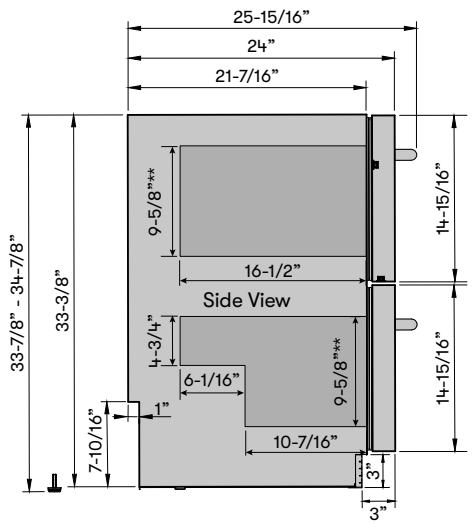
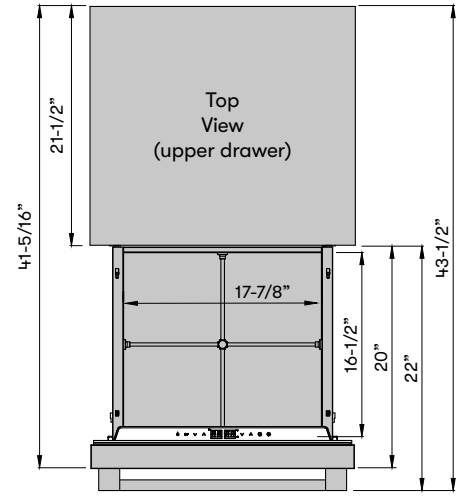

** Maximum clearance height inside drawers is 12"

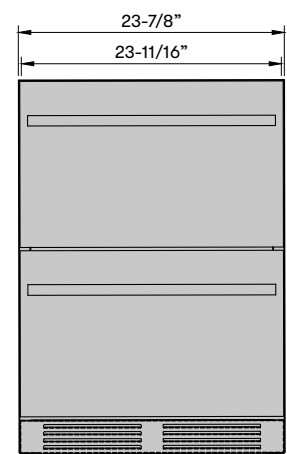

Transforming the Kitchen through Design, Discovery, and Care

Specifications subject to change, check zephyronline.com for up-to-date information.
Zephyr | 2277 Harbor Bay Parkway, Alameda, CA 94502 | 888.880.8368

