

INCA SMART SS INSERT RANGE HOOD



VERSATILE BUILT IN VENT HOOD. The new and improved Inca Smart power pack is perfect for the homeowner who wants a built in range hood that fits into most cabinets and most budgets. This restyled Inca Smart Stainless is now available in 240, 400, 600 CFM with LED lighting!



**NOW WITH TWO MAKE
UP AIR COMPLIANT MODELS**
*ALWAYS CHECK LOCAL CODES

AVAILABLE MODELS

Model #	Size / Color	Motor Class (CFM)	Sound Levels (sones)
INSP28SS240	28 Stainless Steel	240 CFM	0.8 - 3.5
INSP28SS400	28 Stainless Steel	400 CFM	3.0 - 6.0
INSP28SS600	28 Stainless Steel	600 CFM	3.5 - 7.5

KEY FEATURES

Updated Electronic Push Buttons

Backlit electronic controls with a LED light to indicate the current speed. The indicator lights changes colors to indicate the new speed / function

LED Lighting

4 (W) LED energy efficient bulbs offer a warmer light for your cooking surface.

Easy Snap Mounting Clips

Installation made easy with built-in adjustable clips that tighten onto the sides of the cabinet floor

New Self Supporting Liner

The Self Supporting Liner in 30" and 36" cabinet widths. The range hood insert is fully supported by the liner. No need for cut outs or a cabinet bottom. Just attach the liner to the side walls of the cabinet and the hood attaches to the liner.

INCA SMART SS INSERT RANGE HOOD



SPECIFICATIONS

cut out dimensions	26 5/8" w x 10 1/4" d
body width depth	27 5/8" w x 11 1/4" d
height inside cabinet	7 1/16" (28SS240) 12 3/4" (28SS400/600)
mounting height from cooking surface	24" - 30"
convertible to ductless	yes - FILTER4 - (SS240) FILTER1 / FILTER1LL2 (SS400/SS600)
controls	4 speed electronic push w/multi-colored LED
lighting	2 X 4 (w) LED - 1 Level
ducting top	5" round (SS240) 6" round (SS400 & 600)
grease filters	dishwasher safe mesh
built in mounting hardware	yes - easy snap mounting clips
10 minute intensive speed	yes
power cord included	yes- wirebox optional (SS400/SS600)

INSP28SS240

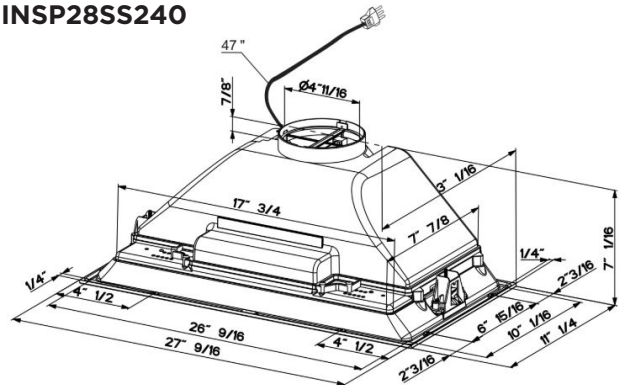

INSP28SS400 / 600

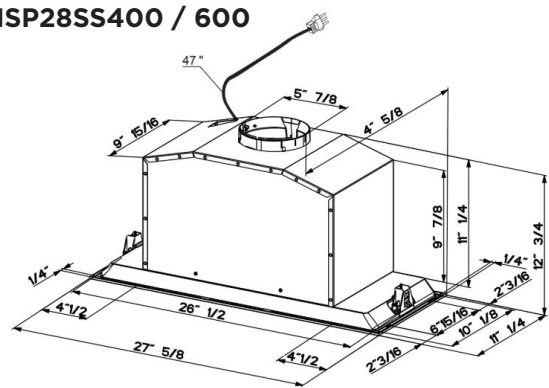

CUT OUT (ALL MODELS)

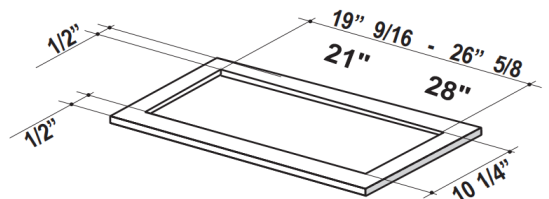

PERFORMANCE

MODEL	1	2	3	4
INSP28SS240	65	130	195	240
INSP28SS400	150	250	350	390
INSP28SS600	150	295	395	560

ACCESSORIES

FILTER1 - Charcoal Filter Kit (INSP28SS400 & INSP28SS600 ONLY)

High quality charcoal filter for use when recirculating the air back into the kitchen. Filters out odor and should be replaced every 6 months.

FILTER1LL2 - Long Lasting Charcoal Filter Kit (INSP28SS400 & INSP28SS600 ONLY)

New washable charcoal filter can be recharged and washed up to 8 times. For use when recirculating the air back into the kitchen. Filters out odor and can last up to 4 years.

FILTER4 - Charcoal Filter Kit (INSP28SS240 ONLY)

High quality charcoal filter for use when recirculating the air back into the kitchen. Filters out odor and should be replaced every 6 months. Some ductwork is required to exhaust the unit out of the cabinet.

WIREBOX - Fixed Wiring Box (INSP28SS400 & INSP28SS600 ONLY)

Replace the power cord with a hard wired box to power the range hood.

LINE30ST / LINE36ST - Stainless Steel Liner 30 & 36"

See page 3 for more information.

LINSPT301228 - Stainless Steel Liner 30"

See page 3 for more information.

LINSPT361228 - Stainless Steel Liner 36"

See page 3 for more information.

Product specifications are subject to change without notification. Consult the installation instructions before you begin installing this range hood. *Check local make up air codes for guidelines.





LINER SPECIFICATIONS

Liners are stainless steel kits that are optional for cabinet insert hoods. They create a metal perimeter to “line” the wood below the range hood with metal. They create a more finished look and move the range hood up creating additional capture area. In some cases, a liner may be required by local code if the cabinet starts at below 30” off the stove (check local building codes). All liners are adjustable in depth with a telescoping frame.

LINE30ST - USE WITH INSP28 ONLY FOR 30” WIDE CABINETS

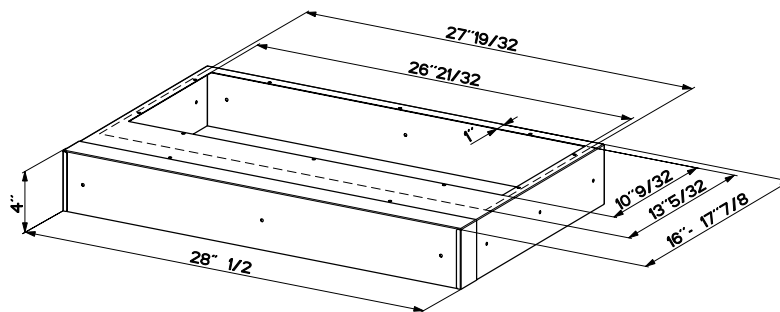

LINE36ST - USE WITH INSP28 ONLY FOR 36” WIDE CABINETS

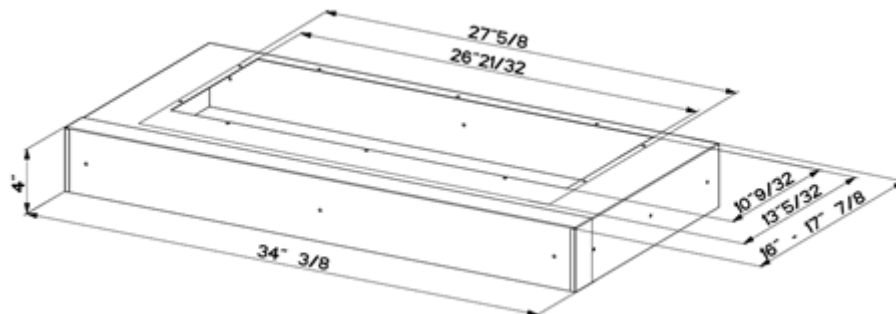

LINSPT301228 / LINSPT361228 SELF SUPPORTING LINER USE WITH INSP28 ONLY

The liner is installed with screws against the walls of the cabinet, aligned with the cabinet bottom. The hood is installed onto the thick metal interior portion of the liner and is fully supported by the liner.

